

NORTH HUMBERSIDE FOREST RALLY 1996.

**Competitors' Bulletin Number 1
Final Instructions**

Issued Saturday 23rd March 1996

This is an Official Instruction.

This bulletin consists of 4 numbered pages.

Thank you for your entry. Your competition number is as shown on the enclosed entry list.

Starting times will be displayed on the Official Notice board at Rally HQ. It is the competitors' responsibility to confirm their start time.

Please do not contact the organisers if you are unhappy with your seeding as it cannot be changed now. (Prove us wrong with a good result! We'll take account of that next year.)

The Service Vehicle Registration Form, and (for those who have ordered a Management Vehicle Pack) a Management Vehicle Registration Form is enclosed. The Service Vehicle Registration Form must be returned, duly signed, to documentation as a pre-requisite for receiving authorisation to start the event. The Management Vehicle Registration Form must be returned to documentation before a Management Vehicle Pack will be issued.

The route passes commercial petrol stations on the run out to stage 1 and again between the last stage (stage 6) and service. Further petrol stations are passed on the route back into Hull. Allowance has been made in the time schedule for the use of these petrol stations to reduce the need to re-fuel competing cars in the service areas.

The following additions/amendments are made to the SRs:

List of Officials. Noise Judge: Add: Andrew Mortimore, Martyn Milner, Malcolm Mumby. Driving Standards Observers: Add: Andy Brown, Joss Horne, Cynthia Mumby, Malcolm Mumby, Ian North.

SR3. PERMIT. DoE Authorisation number will be displayed on the Official Notice Board. The RAC permit number is 43031.

SR4 ELIGIBILITY. Competitors are reminded to check their eligibility before the event. Those that are not members of an invited club or championship will be expected to apply for NHMC membership at signing on at £8 per person CASH.

SR17 SCRUTINEERING, DOCUMENTATION, AND SIGNING ON. Noise test will take place at Gilbert Baitson Auctioneers, Wiltshire Road, HULL MR 107/0672724, where trailers should be unloaded and **may be left at the owners' risk for the duration of the event.** Please do not obstruct the noise test area that will be marked by traffic cones.

On approach to Hull, competitors should leave the A63 at the junction signposted Ring Road & St. Andrew's Quay. Turn left at the bottom of the slip road and take 2nd exit at the roundabout and forward over the flyover. Turn left at the bottom of the flyover into Wiltshire Road, and then first right also Wiltshire Road. Gilbert Baitson is on the right.

There are no security personnel at the trailer park, but the gates will be locked as specified below. **THERE IS NO TRAILER PARKING IN THE CENTRE OF HULL OR AT RALLY HQ (Quality Royal Hotel).** Access to the trailer park is available from 14.00hrs to 22.00hrs on Friday, at which time the car park barriers will be locked until 06.00 hrs on Saturday 30th March. The premises are locked at 19.00hrs on the 30th March. Anyone wishing to move a trailer after this time will have to contact the organisers via the help desk in Rally HQ. Gilbert Baitson's re-opens from 06.00hrs until 14.00hrs on Sunday 31st March.

Noise tests and scrutineering will be available from 17.00hrs to 22.00hrs on Friday 29th March. Documentation will be open from 17.00 to 22.30 on Friday 29th March and on Saturday 30th March from 06.30 until 08.30hrs

After completing noise crews should proceed to scrutineering in accordance with the marshals' instructions. Documentation will take place in the Windsor Suite at the Royal Hotel, Ferensway, HULL MR 107/092288, a location map for Hull is included with this bulletin.

A Process Card will be issued at the noise test. Please check all details on this card are correct and up to date after completing scrutineering and before reporting to documentation. After Scrutineering both crew members should proceed to Documentation. Please follow the instructions of the marshals on duty there. Competitors should take with them all necessary documents (completed Process Card, completed Service Vehicle Registration Form, Competition Licences, Club Membership Cards and/or Championship Registration Cards, and where applicable, NES Insurance Letter, completed Management Vehicle Registration Form, completed Media Form (if not already returned), etc.) **PLEASE NOTE RACMSA have asked that we check all competitors have current addresses on their competition licences, and where applicable NES letters.**

You may collect your route/service packs, etc. immediately after documentation and signing on has been successfully completed. If only one crew member completes documentation, then time cards will not be issued until after the second crew member has also successfully completed documentation.

On Saturday morning before the start of the event and after completing documentation, competitors should report to Paragon Street 30 minutes before their start time as published on the official notice board, and park as directed by marshals. Paragon Street is closed except to rally traffic.

GENERAL. Secure parking has been arranged for competing cars in the Prince's Quay multi storey car park on both the Friday and Saturday nights. Princes' Quay is approximately 5 minutes walk from both Rally HQ (Quality Royal Hotel) and The Comfort Friendly Inn.

This parking will be at the direction of the event marshals and access is only available by means of the pass included in these final instructions from 17.00hrs on Friday 29th March until 22.30hrs, at which time the premises will be locked until 07.00 hrs on Saturday 30th March.

All competitors' cars must be removed from Princes Quay by 10.00hrs on Saturday 30th March. ~~Princes Quay Car Park will be available from 16.30hrs on Saturday 30th March until 22.00 hrs., once again access is by the pass only, after this time cars cannot be removed before 08.00hrs on Sunday 31st March and must be removed before 12.00hrs on Sunday 31st March at which time the car park will close until 09.00hrs on Monday 1st April.~~ Please note that no servicing work other than cleaning windows and lamp glasses may be undertaken in Princes Quay.

Service Vehicles and Management Cars cannot be accommodated at Princes Quay, but can be parked in the undercover converted platform parking at the railway station, situated at the back of the Royal Hotel MR 107/090W288. This car park is linked by an undercover walk way to the rear door of the Royal Hotel. Please note that no servicing work other than cleaning windows and lamp glasses may be undertaken in the station car park.

~~Free parking in the station car park is by means of the pass enclosed with these final instructions only, and the pass is valid from 17.00hrs on Friday 29th March to 10.30hrs on Saturday 30th March and again from 16.30 hrs on Saturday evening. Unless the pass is displayed in the windscreen it is an offence to be parked without displaying a valid ticket purchased from the ticket machine.~~

PLEASE DO NOT PARK IN RESERVED OR DISABLED SPACES, THERE ARE 180 SPACES IN THIS CAR PARK IGNORING RESERVED AND DISABLED, and this is in addition to Princes Quay. PLEASE NOTE IT IS ILLEGAL TO ENTER THE STATION CAR PARK VIA THE BUS LANES INTO THE BUS STATION. HUMBERSIDE POLICE INTEND TO ENFORCE THIS AND PROSECUTE OFFENDERS - YOU HAVE BEEN WARNED. Entry to the car park is via MR 107/091291W and follow the one way traffic signs, or via Anlaby Road and St. Stephens Square as shown on the location map of Hull. Beware of PEDESTRIANS and buses entering and exiting bus parks on route.

Security guards will patrol the station car park and the hotel car park, during Friday night, however this area is not as secure as Princes Quay. Please note the organisers do not accept responsibility for any loss of property or damage to property in any of these parking areas.

PETROL. Petrol is not available at the start venue, Princes Quay, or Gilbert Baitson's premises. There are numerous petrol stations on the route out to the first stage, the last being shown in the roadbook in East Ayton village 10 miles from stage 1.

TRAILER PARKING

Trailers will not be permitted at the service areas due to lack of room, or at The Quality Royal Hotel. **THIS INCLUDES COMPETITORS WHO ARE STAYING IN THE HOTEL** and is at the request of the management as other members of the public are using the hotel. Please be sensible there is ample parking arranged for all during the weekend.

CHICANES AND TIGHTENED JUNCTIONS. Chicanes (temporary and permanent) are being used on some straights and some junctions may be artificially tightened. All these features will be indicated in the Roadbook, and will be marked on the stages by a diagrammatic board instead of an advance arrow. Temporary chicanes will be marked by chevrons at the site of the chicane. Permanent chicanes and tightened junctions will be arrowed as junctions. Permanent chicanes are narrow with high banks; temporary chicanes will be of a solid construction - **both types of chicanes are intended to reduce competitors' speed dramatically...**

ACCOMMODATION. Competitors who have booked accommodation via the organisers' booking form should report to the Quality Royal Hotel Reception.

POST EVENT PARKING

Competitors arriving in Hull after completing the event but before 16.30 are advised to park first at the Royal Hotel or the undercover station car park, the St. Stephen's Square car park MR107/089289, or the Ferensway car park MR107/0914290. It will be necessary to purchase a ticket at the latter three from the ticket machines. All four parking areas are within 5 minutes walk of Rally HQ. For those with other transport it will be possible to park service barges at Gilbert Baitson's. Please note the organisers cannot accept responsibility for the safety of vehicles in any of these venues.

Please note **YOU CANNOT PARK IN PRINCES QUAY BEFORE 16.30HRS** unless you are going to remove your vehicle(s) from the car park before 18.00hrs and are purchasing a valid ticket. Attempting to do so will cause a problem with the ticket machines and may mean that the management will refuse secure overnight parking there for future events.

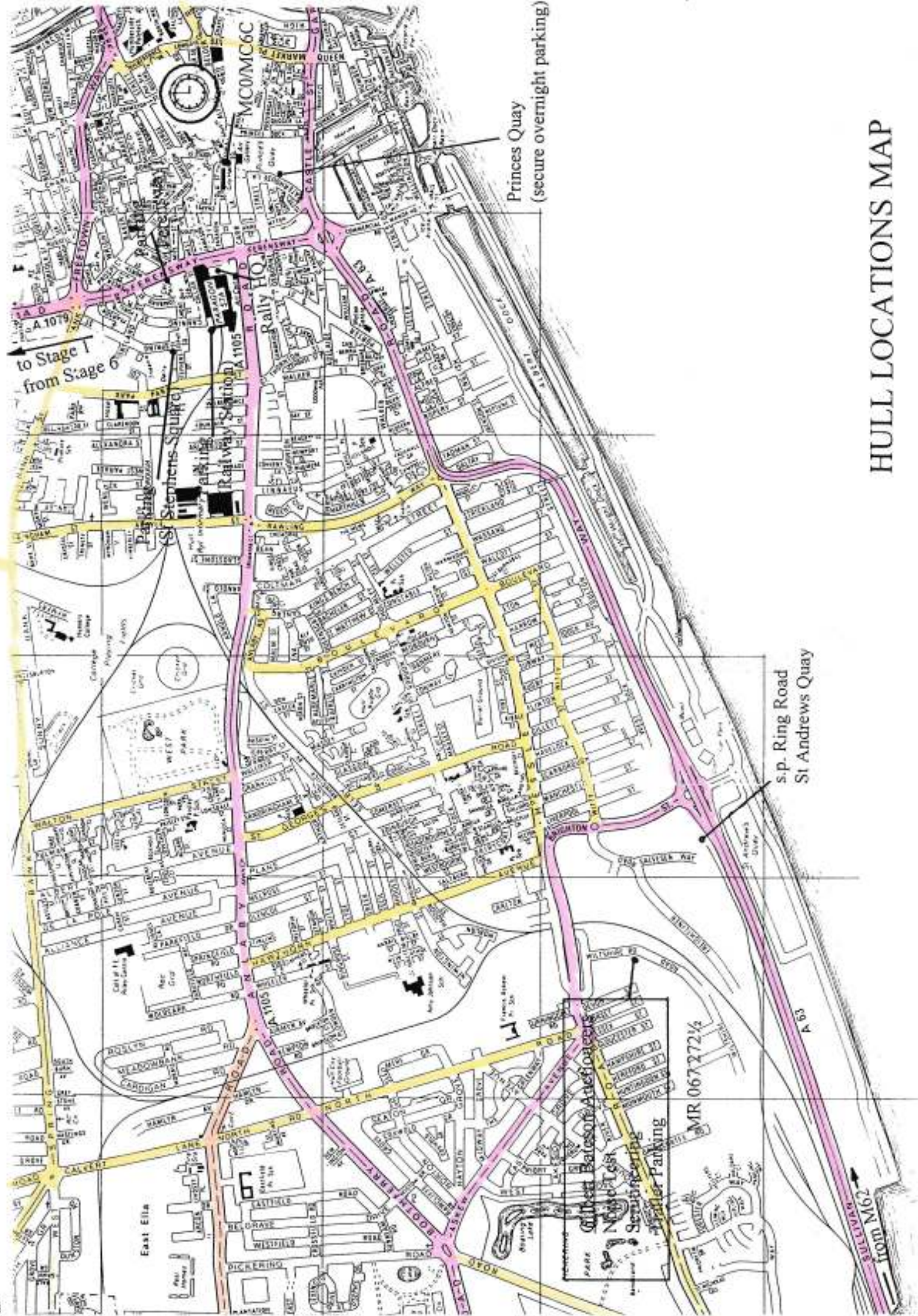

to Stage 1
from Stage 6

Princes Quay
(secure overnight parking)

s.p. Ring Road
St Andrews Quay

Gilbert Balfour Auctioneers
MR 067272 1/2
Seminole Parking
A63

HULL LOCATIONS MAP

Gilbert Baltson Auctioneers
Noise Test, Scrutineering, & Trailer Park

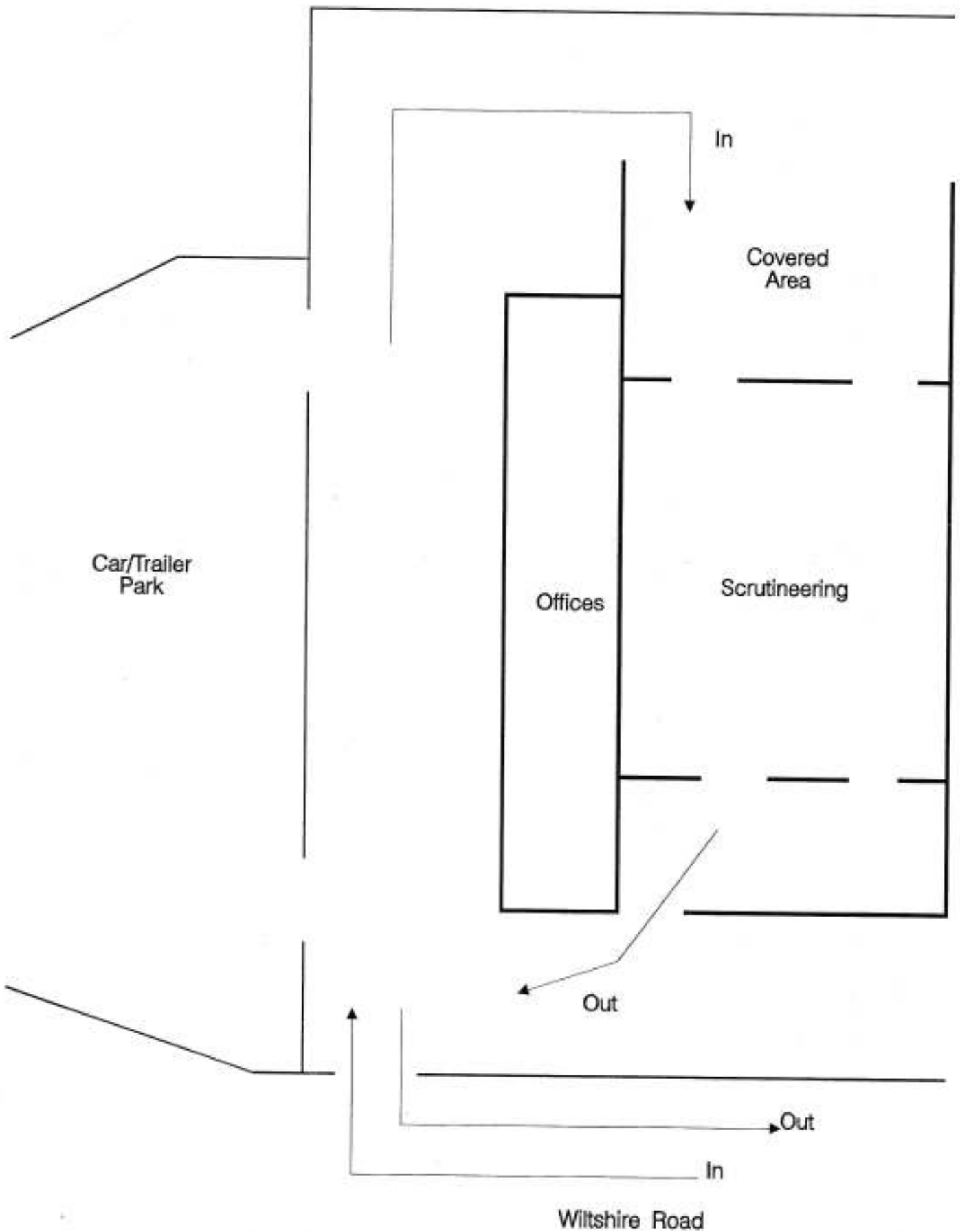

SCHEDULE OF CONTROLS AND SPECIAL STAGES

1. The times shown are schedule times for competitor '0' at MC0. At all other controls they are the organisers' estimate of the running time of competitor '0'.
2. Special Stages and Controls will close at one minute after the Maximum Permitted Lateness Time of the last competitor still within his/her Maximum Permitted Lateness.
3. Target Times for the Road Sections, Service Areas, and Special Stages are shown in the Road Book and on the Time Cards. Bogey Times for the Special Stages are shown on the Time Cards.
4. Each Special Stage will be preceded by an Arrival Time Control (SS1A, SS2A, etc). A Time Control will also be combined with the 'STOP' position of each Special Stage. These controls will be denoted as SS1F, SS2F, etc.
5. Time Cards will be collected at PC2, PC3A, PC6, and MC6C. The Time Cards which should be given to the Control Officials are listed at the appropriate point in the Roadbook. In addition, the collection point for each card is marked on that card.

Start to Service 1	57 road miles/11 stage miles approx (2 stages)
Service 1 to Service 2	23 road miles/34 stage miles approx (4 stages)
Service 2 to Finish	43 road miles

All special stages are 100% Forestry Commission loose surface, with the following exceptions:

stage 3 contains 0.29 miles of tarmac and 0.07 miles of concrete,
stage 4 contains 0.35 miles of tarmac.

ONCE AGAIN, THANK YOU FOR YOUR ENTRY AND WE HOPE YOU HAVE A SAFE, SUCCESSFUL, AND ENJOYABLE DAY'S MOTORSPORT.

COMPETITORS' ROUTE BY MAP REFERENCE/TIME SCHEDULE

CONTROL	MAP REF	APPROX TIME CAR '0'	REMARKS	ROAD TARGET (IN MINUTES)	STAGE TARGET
MC0	107/096 287 ✓	08:30	City Hall, Hull		
via	107/093 287 ✓				
via	107/075 345 ✓		Beverley		
via	107/043 409½ ✓				
via	107/022 411½ ✓				
via	107/012 565½ ✓		Driffield		
via	107/020½ 589 ✓				
via	101/015 790 ✓		Staxton		
via	101/024 794 ✓				
via	101/019 814 ✓				
via	101/014 839 ✓		Seamer		
via	101/992 849 ✓		West Ayton		
via	101/989½ 849 ✓				
via	101/967½ 899½ ✓		Hackness		
via	101/935½ 914½ ✓				
via	101/933½ 921½ ✓				
SS1A	101/906 960½	10:20	Langdale	110	
SS1 Stop	101/922 935				10
via	101/925½ 926				
via	101/909 927		Outdoor Pursuit Centre		
via	101/914½ 921½				
via	101/903 906				
SS2A	101/902 909½	10:42	Staindale	14	
SS2 Stop	101/879 901				13
via	101/878 902				
PC2	101/889½ 890½		Dalby Fire Tower		
via	101/885 887				
TC2A	101/894½ 877	11:05	Givendale Head	14	
via	101/891½ 887½				
TC2B	101/889½ 890½	11:50	Dalby Fire Tower	45	
via	101/885 887				
TC2C	101/882 884½	12:00	Regroup In	10	
RC2D/SS3A	101/879 882	12:15	Dalby		
SS3 Stop	100/856½ 879½				30
PC3A	100/855½ 879½		Low Dalby		
via	100/841 851				
via	100/845 882		Fox and Rabbit		
via	100/848½ 898½				
PC3B	100/833 906		Levisham		
via	100/818 910½		Levisham Station		
SS4A	100/818 932½	12:57	Gale Rigg	25	
SS4 Stop	100/804½ 969				12
via	100/802½ 969				
via	100/801 963½				
SS5A	100/800½ 963½	13:12	Pickering	6	
SS5 Stop	100/822 956				10
via	100/822½ 952½				
via	100/795½ 943		Mauley Cross		
via	100/797½ 951				
SS6A	100/795½ 951½	13:26	Cropton	9	
SS6 Stop	100/764 911				24
via	100/766 911				
via	100/766 913				
PC6	100/767 912½		Sutherland Lodge		

via	100/766	909½			
via	100/774	894		Cawthorne	
via	100/766	859½		Wrelton	
via	100/772	858			
via	100/799	838½		Pickering	
TC6A	100/802	805	14:02	Slaters Transport	22
TC6B	100/802	805	14:17		15
via	100/801½	734½			
via	100/787	716		Malton	
via	100/797	714		Norton	
via	100/860	666½			
via	101/916	600	✓		
via	106/922½	590	✓		
via	106/935½	591	✓	Wetwang	
via 965/519	106/955	519	✓	Bainton	
via	106/002	414½	✓		
via	106/030	367½	✓		
via	107/075	345	✓		
via	107/093	287	✓		
MC6C	107/096	287	✓	City Hall, Hull	92
Parking	107/096	286		Princes Quay	